

Occhio

Sento body verticale

Mounting instructions

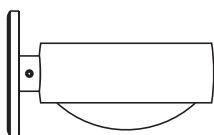

up
flat

Contents

Safety precautions	4
Product description	5
Assembling the body	7
Appendix	23
Information	24
Technical data	25

Safety precautions

Read through the mounting/use instructions carefully before installing the luminaire. Follow the safety precautions in these instructions closely and keep the instructions in a safe place.



This symbol warns you of a dangerous situation which could lead to serious injury or even death if the instructions are not observed. It also draws your attention to possible material damage and provides other important information in connection with this product.



This symbol warns you of hot surfaces, which could cause burns if touched.



This symbol draws your attention to situations in which you could look directly into the light of the LED. This may cause an after-image effect and may result in damage to the eyes if you look at the light directly for prolonged periods.

General safety precautions



The assembly and installation of electrical components must be carried out only by qualified personnel. Repairs must be carried out only by authorised, qualified personnel or the manufacturer. Before performing any work on the spotlight (installation, changing the light source, cleaning, etc.), it must be disconnected from the mains supply.

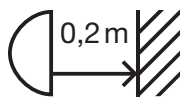

Maintain the minimum safety distance from flammable materials: 20 cm.



Caution: When used for prolonged periods, the surface of the spotlight can become hot.

Before performing any work on the spotlight (fitting the spotlight, changing the light source or insert, etc.), always switch the spotlight off and let it cool for at least 30 minutes.

Product description

Thanks to the modular LED head/body system, it is possible to combine a head, body and base each with different surfaces. The head can be taken off for configuration and maintenance; replaceable LED. Heads with single-sided or double-sided light output are available; luminous power 18 W or 26 W.

Lighting effect can be changed through optional inserts; dichroitic colour filter can be additionally inserted.

Adjustable thanks to the heat-insulated carbon rod. As an option, the head can be secured against turning.

up-Version

LED wall-mounted luminaire with high base incl. power supply unit (converter) for mounting on a solid wall; connection to 230 V.

Externally dimmable by trailing-edge phase-cut dimmer or by gesture-controlled „touchless control“ on the head.

flat-Version

LED wall-mounted luminaire with flat base for mounting on a hollow ceiling box; connection to an external constant-voltage source (converter).

Externally dimmable (depending on power supply unit) or by gesture-controlled „touchless control“ on the head.

Assembling the body

Sento verticale up
for solid walls



9

Sento verticale flat
for hollow ceiling/plastering box

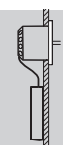

17

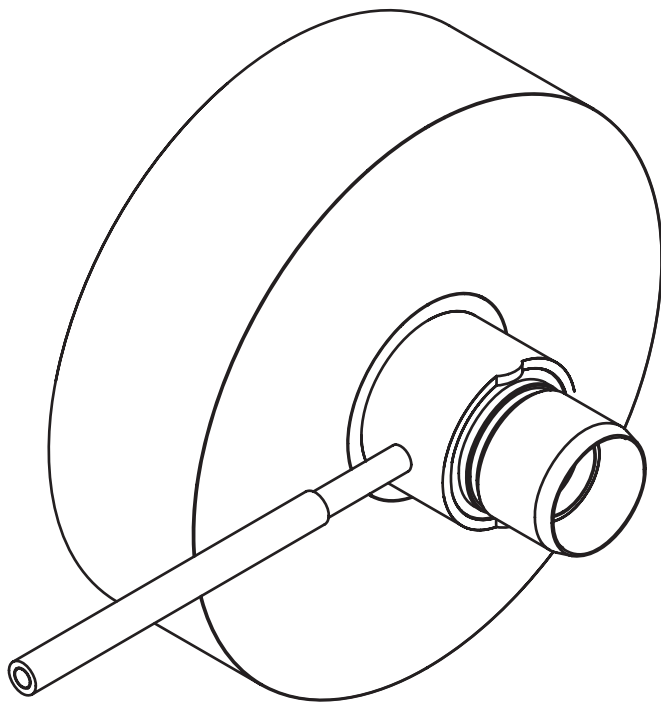

Sento verticale up

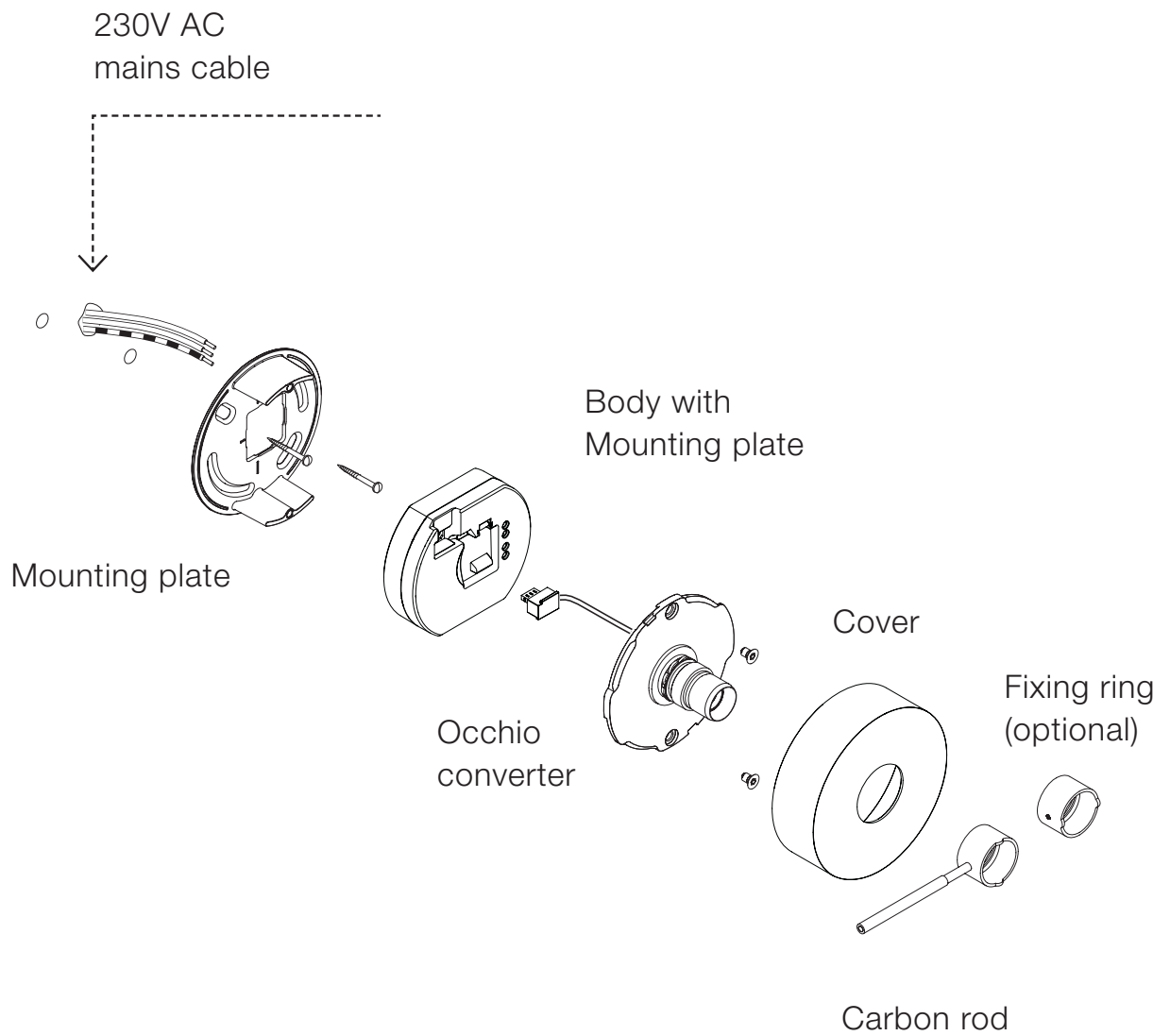

Installation

230V AC
mains cable

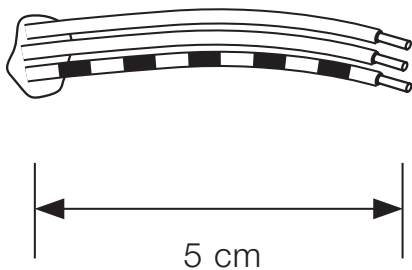

Cut the mains cable to a length of 5 cm and strip the insulation from the ends.

Wall mounting: Orient the threaded holes vertically.

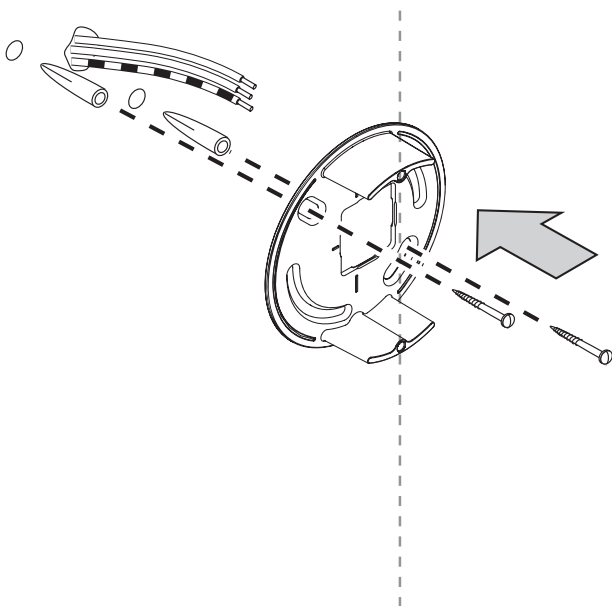

Place the mounting plate over the power outlet and against the wall, and turn it until the elongated holes are oriented as required. Mark the positions where the holes are to be drilled. Orient the threaded holes vertically.

Check the routing of the power cables.

Drill two 6 mm diameter holes, push in the rawlplugs so that they lie flush and screw on the mounting plate (screws and rawlplugs are included in the scope of delivery). Ensure that the screws finish flush with the mounting plate.

Sento verticale up

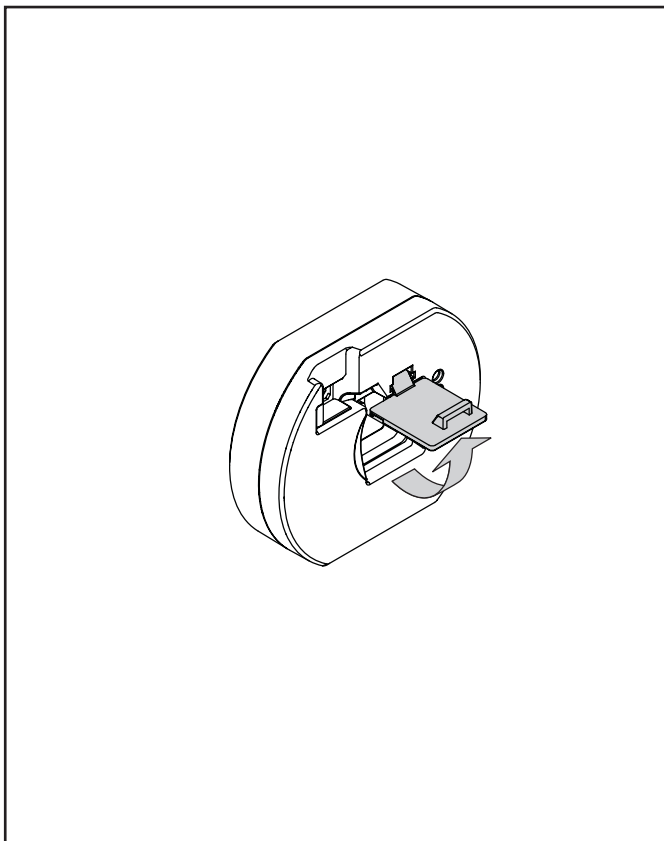

Using a screwdriver, open the flap in the middle of the converter.

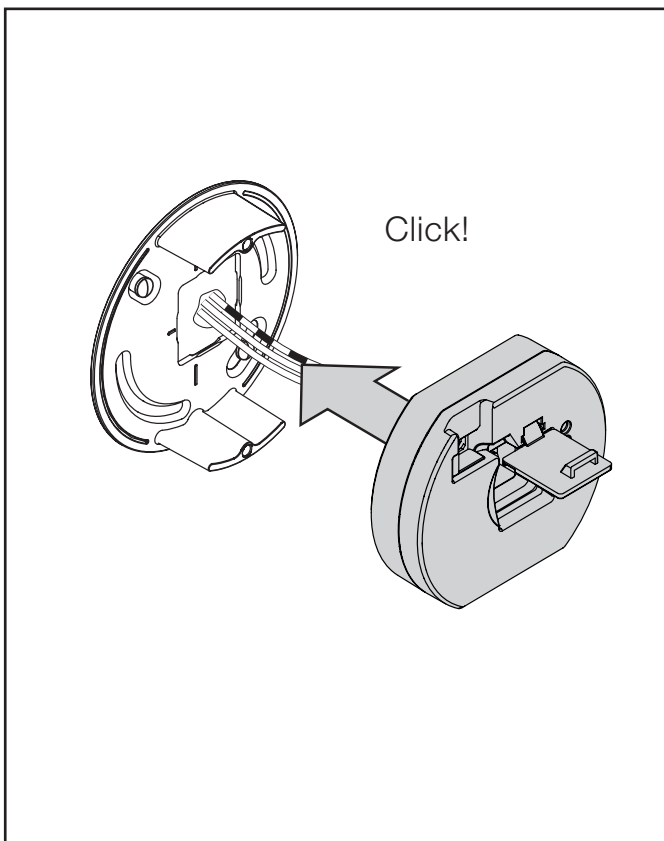

Lock the converter into the mounting plate so that it is fitted flush.

At the same time, guide the ends of the mains cable through the converter opening.



Caution:
Before fitting, disconnect all current-carrying lines from the mains supply.

Installation

Connected separately

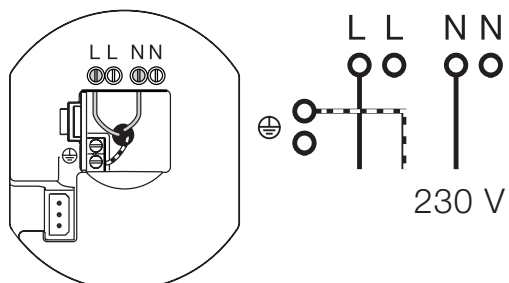

Connected with through-wiring

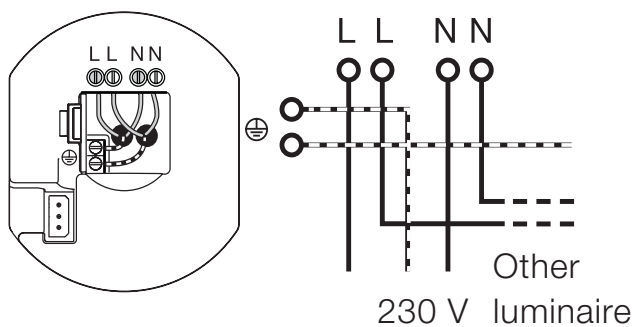

Connect the ends of the mains cable to the converter terminals in accordance with the diagram.

Close the flap of the converter.

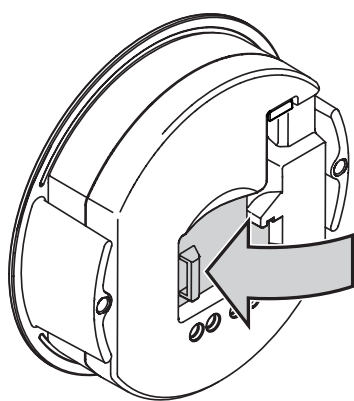

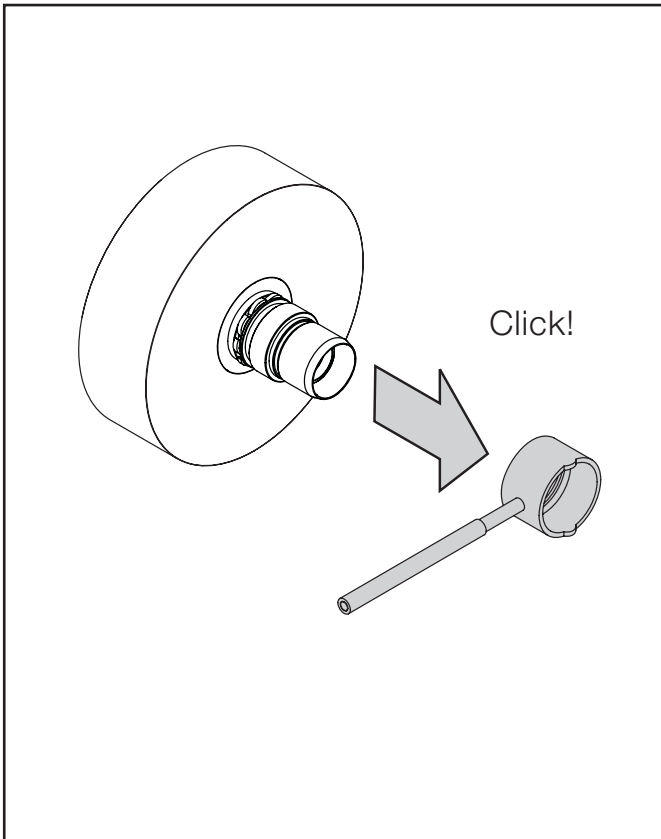

Remove the carbon rod from the body.

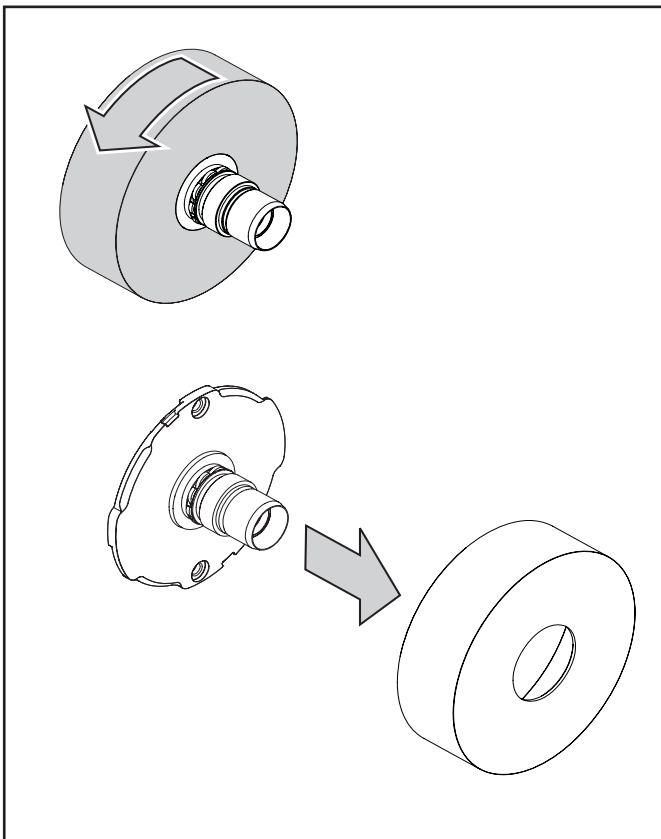

Undo the cover by turning it anti-clockwise and remove it.

Installation

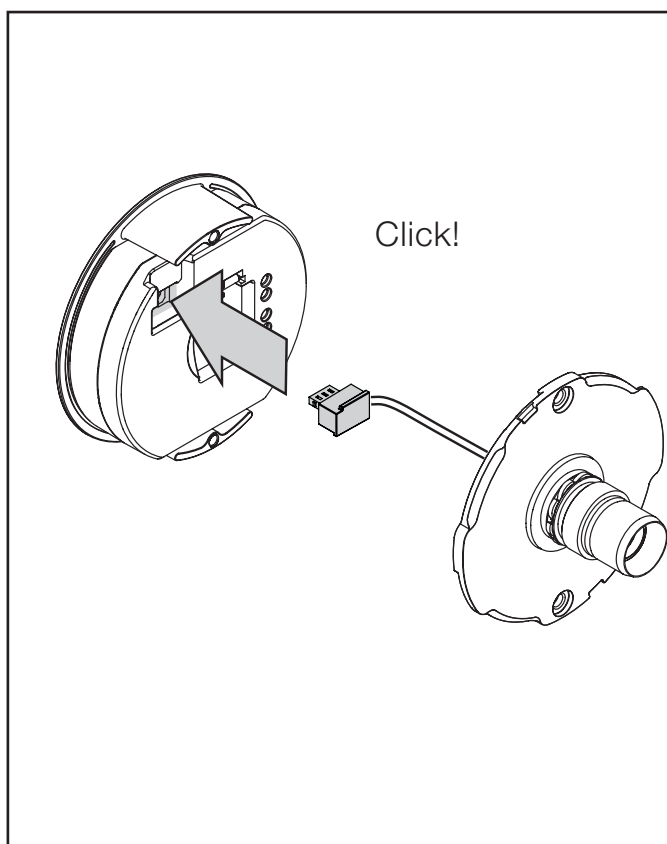

Insert the plug of the luminaire body into the socket of the converter.

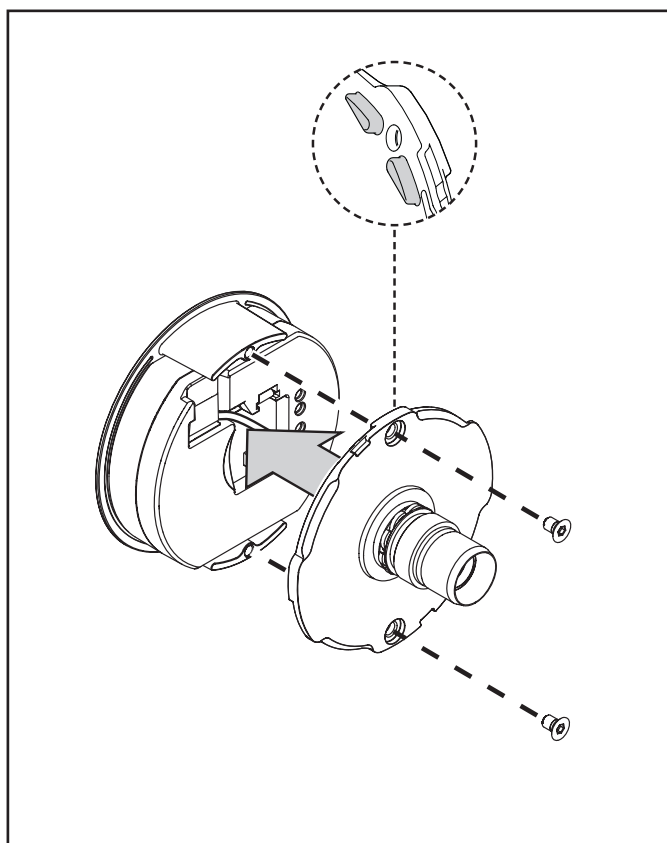

Lay the cable in the recess of the converter. Do not trap the cable.

Screw the luminaire body onto the two spacers of the mounting plate using the screws (Allen) provided.

When doing so, ensure that the snap tabs on the luminaire body (see detail) rest flush on the spacers.

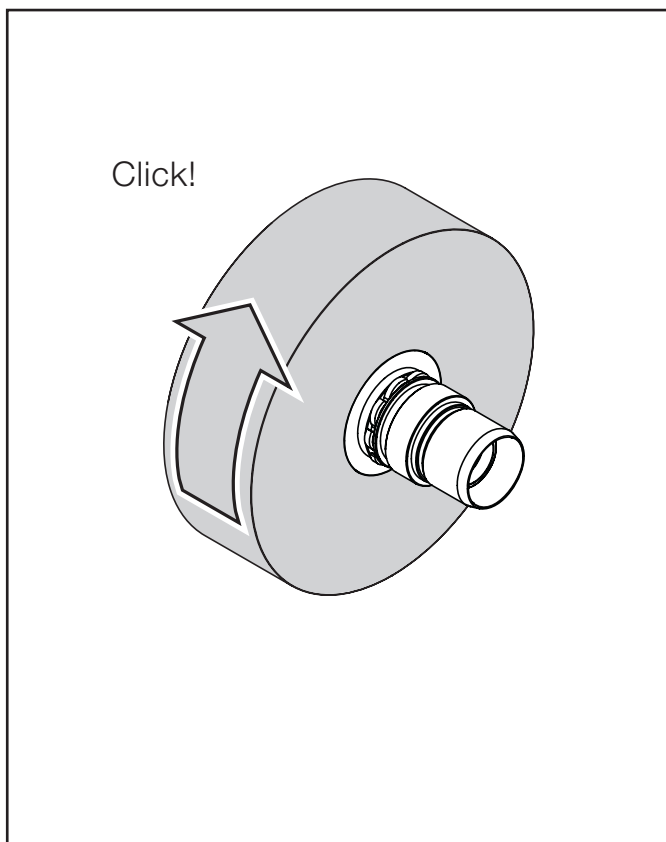

Remove the protective film from the cover.

Carefully guide the cover over the luminaire stem.

Turn clockwise and lock in place.

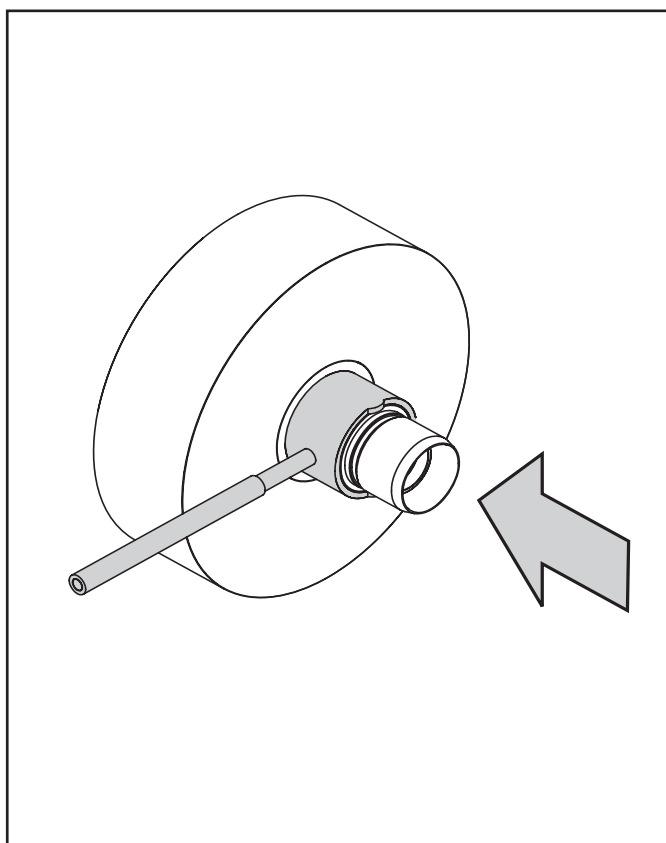

Fit the carbon rod.

Orientation as illustrated.

The body is now fully assembled.
To assemble the head: See „Assembling the head“.

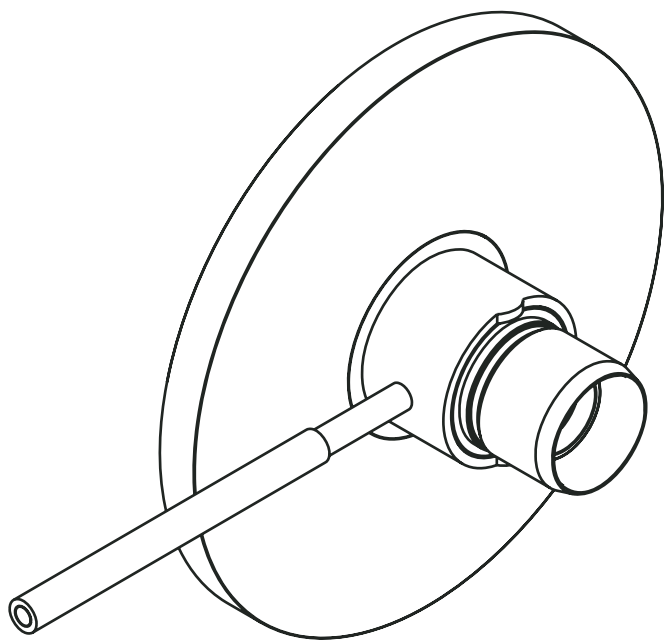

Sento verticale flat

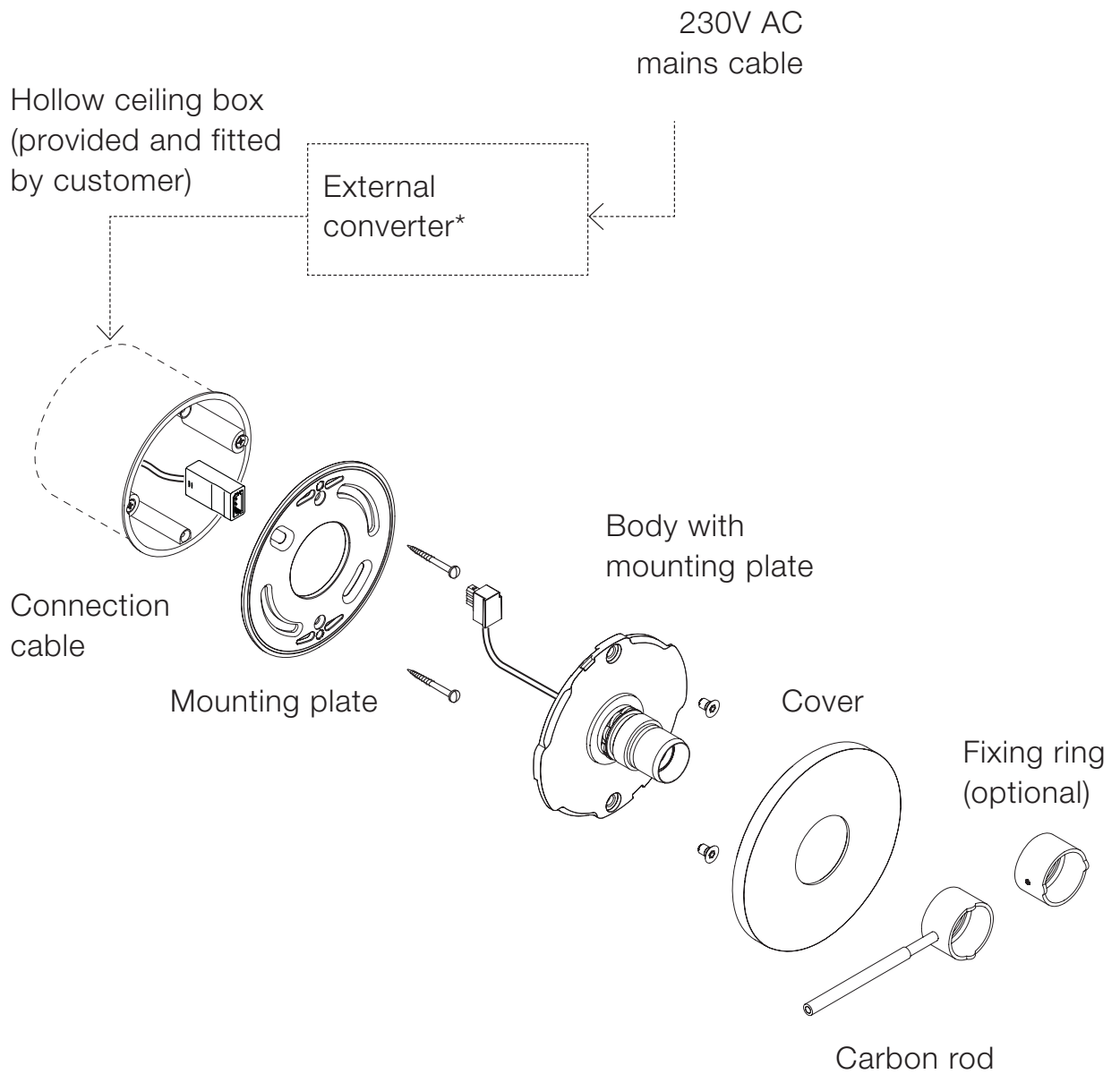

* External LED converter (DC voltage source)
48 V DC, min. 30 W

Installation

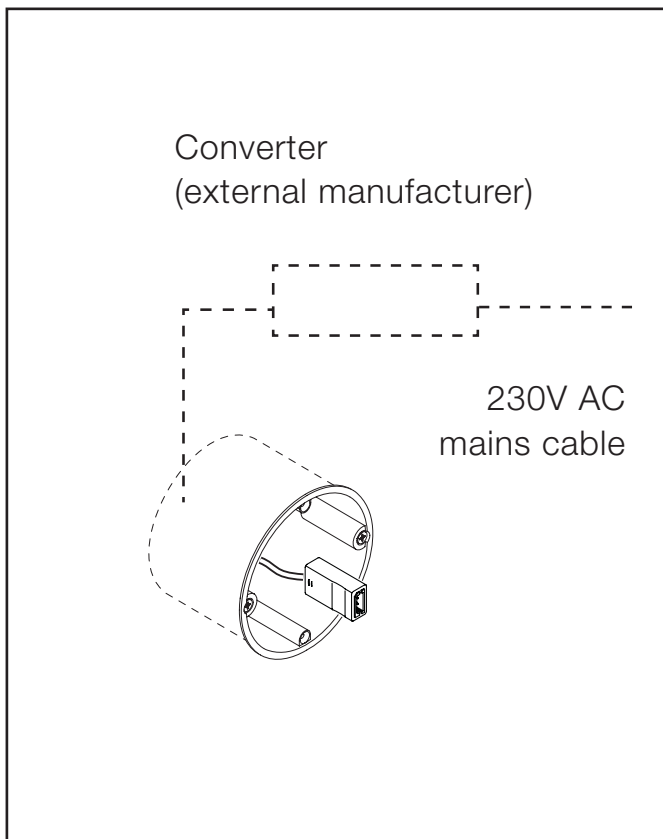
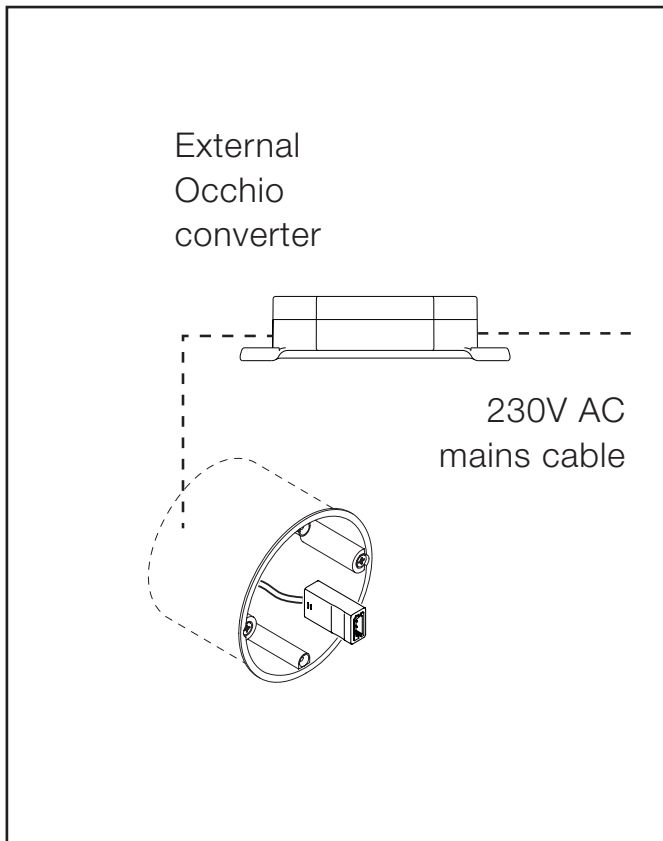

To connect an external Occhio converter:

Correctly connect the converter to the mains cable.

Guide the socket of the LED connection cable to the outside through the hollow ceiling/plastering box.

Connecting a converter from an external manufacturer (see supplementary sheet for the converter):

Connect the converter to the mains cable as shown in the wiring diagram. Connect the cable with the LED socket to the converter. Observe the technical instructions of the particular manufacturer.

Black = positive pole, white = negative pole

Guide the socket of the LED extension cable to the outside through the hollow ceiling/plastering box.



Caution:

Before fitting, disconnect all current-carrying lines from the mains supply.

Sento verticale flat

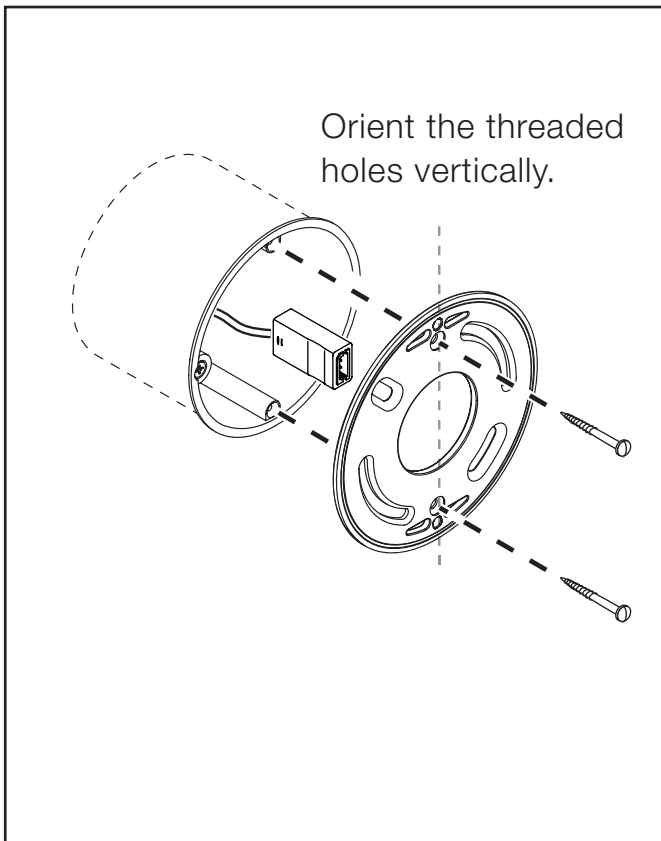

Screw the mounting plate to the hollow ceiling box. As you do so, guide the socket of the LED connection cable through the opening.

Ensure that the screws finish flush with the mounting plate.

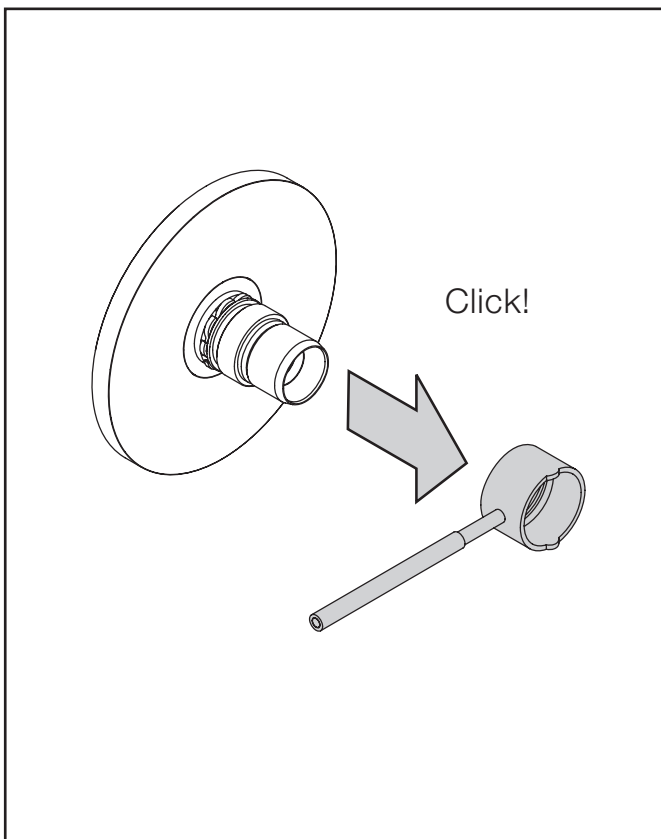

Remove the carbon rod from the body (not necessary for the version with fixing ring).

Installation

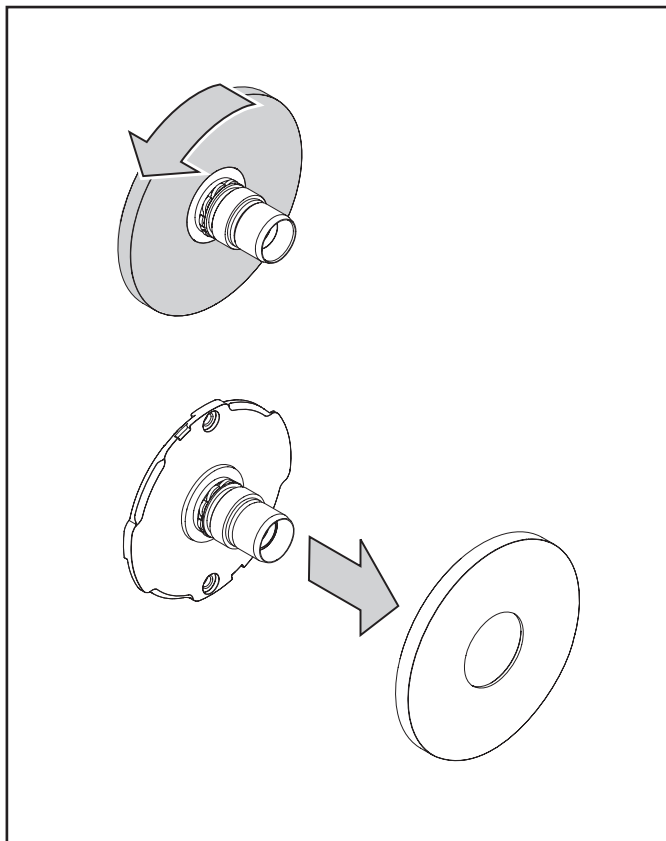

Undo the cover by turning it anti-clockwise and remove it.

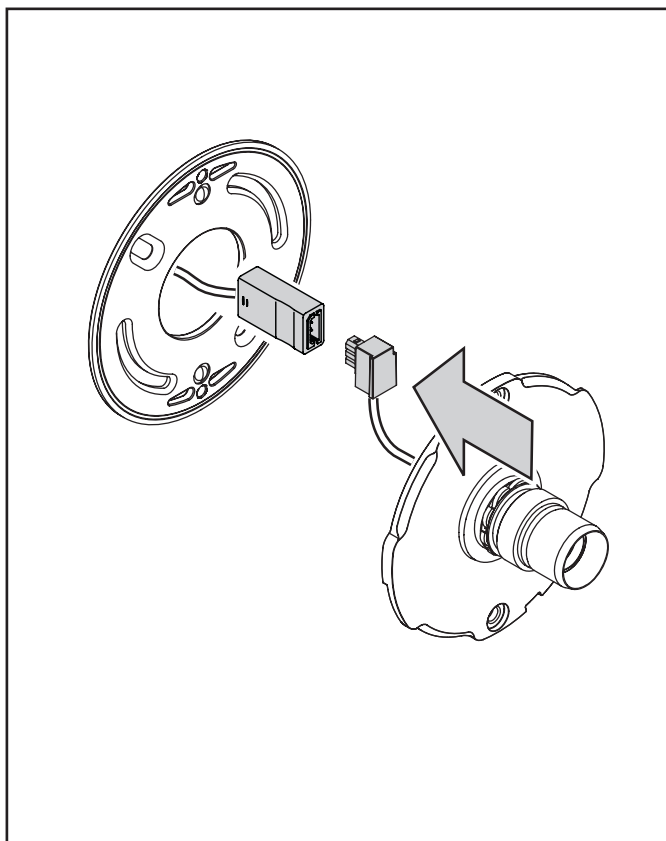

Connect the plug of the body to the socket of the LED connection cable.

Sento verticale flat

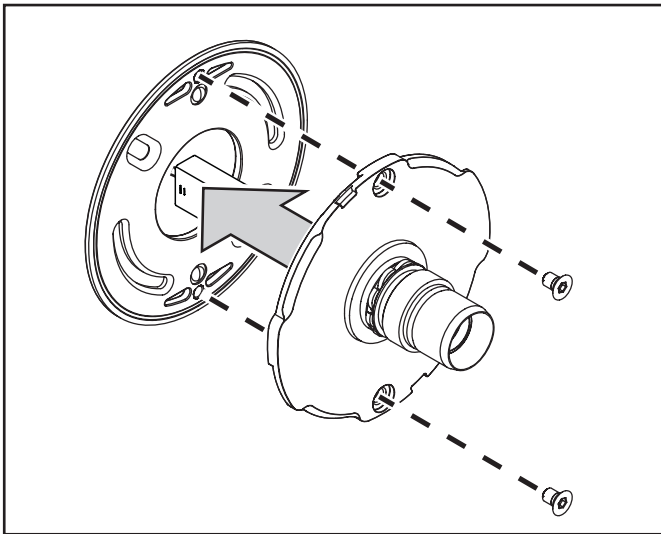

Guide the cable with the plug connection back into the hollow ceiling box.

Screw the luminaire body onto the mounting plate using the screws (Allen) provided.

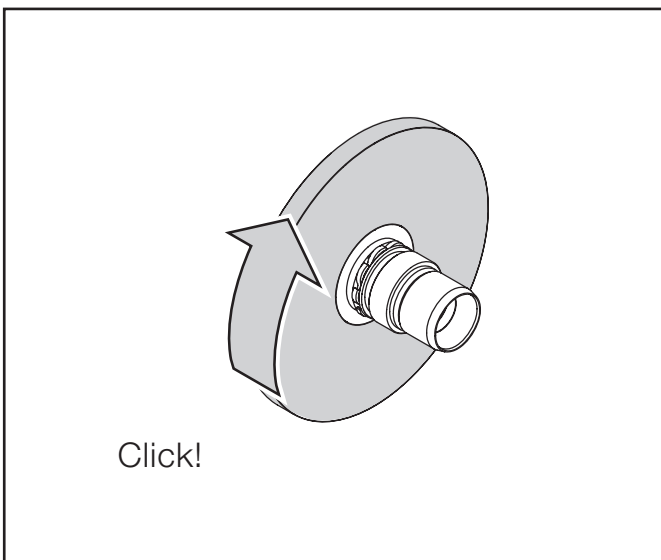

Remove the protective film from the cover.

Carefully guide the cover over the luminaire stem.

Turn clockwise and lock in place.

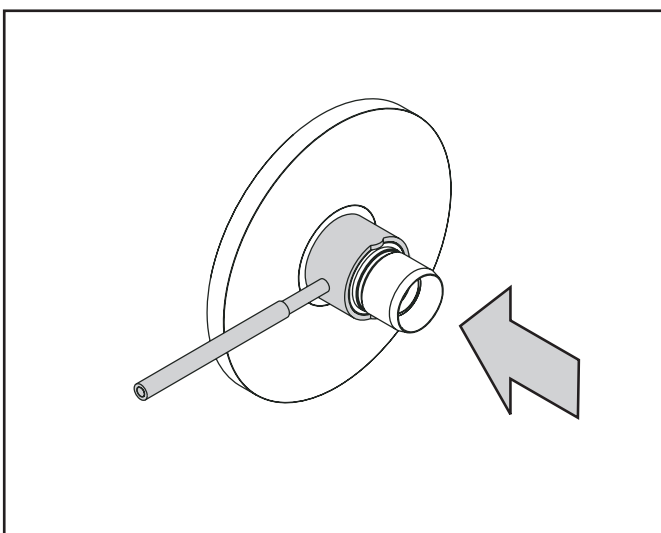

Fit the carbon rod.

Orientation as illustrated.

The body is now fully assembled. To assemble the head: See „Assembling the head“.